



**CTEK MXS 5.0
TEST & CHARGE**

12V/5A



ADVANCED CHARGER WITH UNIQUE BATTERY AND ALTERNATOR TESTING

The MXS 5.0 TEST & CHARGE combines an advanced micro-processor controlled battery charger with a battery and alternator test function to provide the ultimate in battery testing, charging and maintenance.

Charging – The MXS 5.0 TEST & CHARGE provides excellent performance on batteries from 1.2Ah up to 110Ah. The charger solves a broad range of battery problems and features include a patented automatic desulphation step and a special reconditioning step that will revive and restore deeply discharged and stratified batteries. The patented Float/Pulse maintenance makes the charger ideal for long-term maintenance. The **RECOND** and ❄️ option operate individually or together in both 🏍️ and 🚗 programmes providing great flexibility for the user.

Testing – Three easy to use programs to test battery voltage, start power and alternator performance to provide a complete picture of battery and vehicle charging system health.

The MXS 5.0 TEST & CHARGE is easy and safe to use, protects vehicle electronics, spark-free, reverse polarity protected and short circuit proof. The MXS 5.0 TEST & CHARGE features a 5-year warranty.

TECHNICAL DATA

CHARGING VOLTAGE	14.4/14.7/15.8V
CHARGING CURRENT	Max 5A
TYPE OF CHARGER	8 step, fully automatic charging cycle, 3 voltage test programs
TYPE OF BATTERY	12V lead-acid batteries
BATTERY CAPACITY	1.2 - 110Ah, up to 160Ah for maintenance
INSULATION	IP65 (splash and dust proof)

4

Step 4 - Battery ready to use

7

Step 7 - Fully charged battery

8

Step 8 - Maintenance charging



Program for charging small batteries



Program for charging medium batteries



Option for charging in cold conditions and **AGM** batteries

RECOND

Option recondition of deeply discharged batteries

BATTERY

Test battery voltage

START POWER

Test battery starting power

ALTERNATOR

Test alternator charging performance



THE SMARTEST BATTERY CHARGERS IN THE WORLD



CTEK COMFORT CONNECT-eyelet M6

CTEK MXS 5.0
TEST&CHARGE



CTEK COMFORT CONNECT-clamp

Complete battery care – unique and patented system to recover, charge and maintain all lead-acid battery types to maximise performance and extend life.

Safe and easy to use – user safety through spark free operation and reverse polarity protection. Vehicle electrical safety through exceptionally clean voltage and current delivery with no surges or spikes. No need to disconnect battery from the vehicle when charging.

"Connect and forget" – simple plug and play operation. Select the program and mode and leave the charger to do the rest.

Unique 8 step charging – the patented 8 step programme tests battery condition and revives, charges and maintains to ensure maximum battery life and performance. RECOND recovers deep discharged and stratified batteries. FLOAT/PULSE maintenance ensures ideal battery care during periods of inactivity.

Tests battery and alternator – three unique and simple to perform test programs to establish condition and performance of battery and vehicle charging system.

Extends battery life – the unique features of CTEK chargers combine to maximise performance and extend battery life.

GUARANTEED QUALITY WITH CTEK

CTEK customer support is available to answer any questions related to charging and CTEK chargers. Safety, simplicity and flexibility characterizes all products and solutions developed and sold by CTEK. CTEK supply chargers to more than 60 countries throughout the world. CTEK is also a reliable OEM supplier to many of the world's most prestigious car and motorcycle manufacturers.

Contact customer support: info@ctek.com

UNIQUE 8 STEP CHARGING FROM CTEK

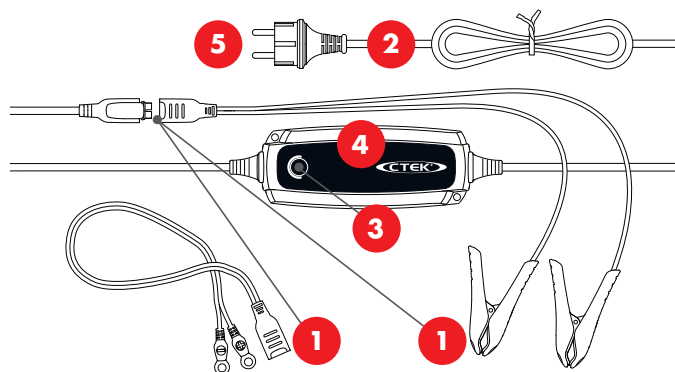

1. Connect the charger to the battery.
2. Connect the charger to the wall socket.
3. Press the MODE-button to combine charging program or with options and/or **RECOND**.

Press and release the MODE button several times until the desired combination of charging program (,) and options (, **RECOND**) is lit.

4. Follow the 8-step display through the charging process.
The battery is ready to start the engine when STEP 4 is lit.
The battery is fully charged when STEP 7 is lit.
5. Stop charging at any time by disconnecting the mains cable from the wall socket.

TESTING

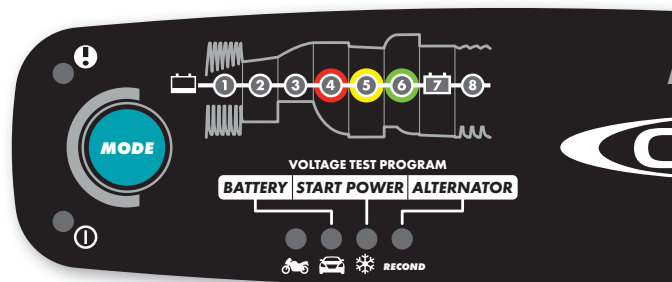

1. Connect the charger to the battery
2. Press MODE to select a TEST program
BATTERY: testing battery performance
START POWER: testing battery performance when cranking engine
ALTERNATOR: testing alternator charging performance

3. Check the result:

	BAD 	FAIR 	OK
BATTERY	< 12.4V	12.4 - 12.65V	> 12.65V
START POWER	< 9.6V	9.6 - 10.5V	> 10.5V
ALTERNATOR	< 13.3V	13.3 - 14.0V	> 14.0V

